

# Skyline Parking

More parking in less space...anywhere.

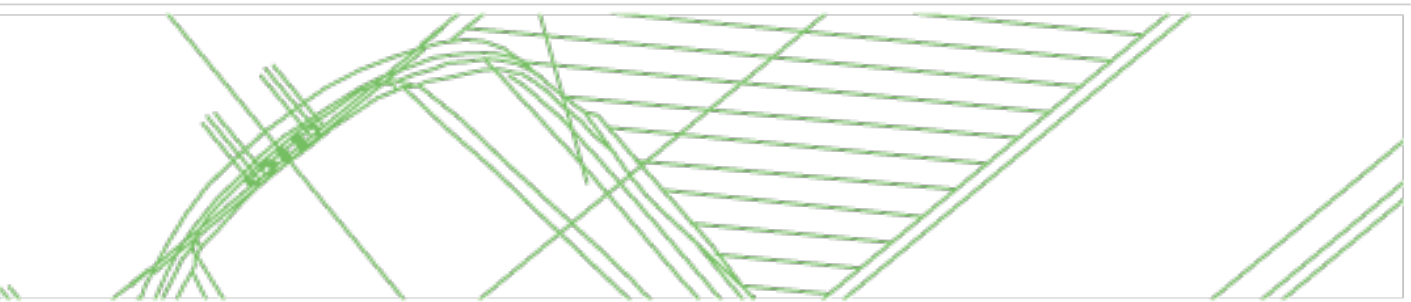

Corporate Brochure

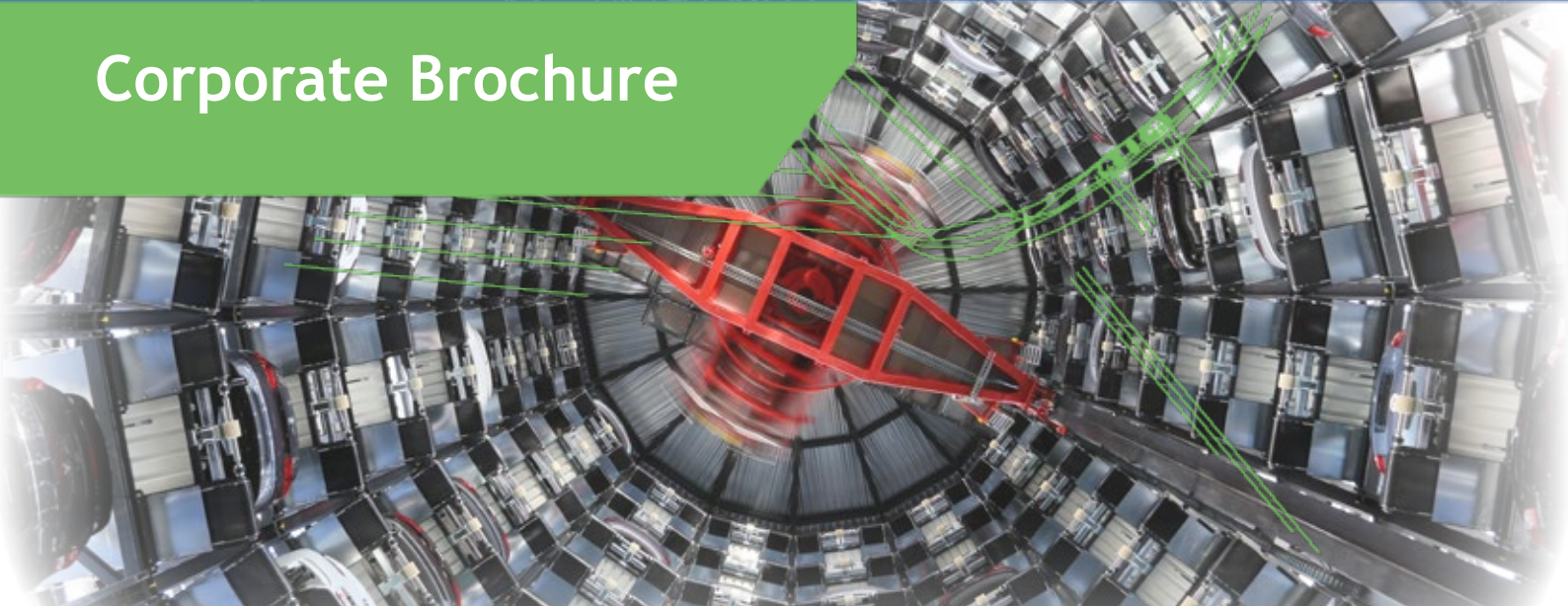

## What is Automated Parking?

**A**utomated Parking is best described as mechanical valet parking where the driver exits the car and it is parked automatically without needing to drive to a parking space or use a valet.

## How Automated Parking Systems (APS) work

### 1. Entry and Scanning

The car is driven into a secure and well lit entry lobby. The driver locks the car, exits the lobby taking his/her parking ticket and leaves.

The system scans the vehicle with laser sensors. The system software matches the size of the vehicle to an available space (maximizing parking density).



### 3. Retrieval

To retrieve a car, the driver enters his/her parking ticket into a kiosk and gets informed about the lobby in which he/she can collect the car. The mechanical shuttle picks up the car from the parking space and delivers it to the designated exit lobby already oriented to drive out. Automatic doors open and the driver picks up his/her car and drives away.



### 2. Parking

The car is automatically transported by a mechanical shuttle to the designated parking position.

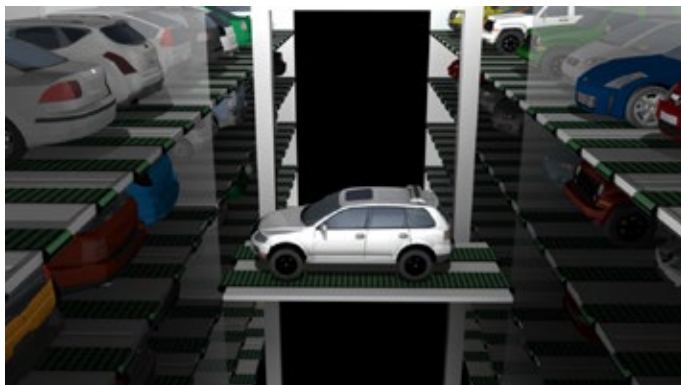

[▶ Animation „How it works“](#)

## Benefits of Automated Parking Systems

### 1. Space Efficiency

Compared to conventional parking facilities, APS require much less area and volume to park an equivalent number of cars. Skyline Parking systems include the capability to measure the car in three dimensions, allowing the system to choose the smallest available parking space for the car. Skyline APS save up to 50% of building volume compared to conventional parking by eliminating the requirement for large parking spaces to allow for pedestrian access, opening car doors, vehicle ramps, circulation routes, walkways, stairs, passenger lifts etc.

### 2. Design Flexibility

The application possibilities for a Skyline APS are virtually unlimited: above ground, underground, free-standing, under building or integrated into existing buildings. They can create parking in spaces where conventional parking is impossible or impractical, such as very narrow or irregularly-shaped areas. A plot measuring just 22 x 22 metres enables the construction of a Skyline APS with up to 200 parking spaces.

### 3. Sustainability

Skyline APS reduce the CO<sub>2</sub> emissions by at least 80% as they eliminate the need for cars to circle, idle and search for parking spaces. Furthermore, the environmental benefits of Skyline APS start in the construction phase by requiring less building materials, much less excavation volume, shorter construction times and reduced construction disruption and traffic congestion.

### 4. Security and Speed

Vehicles park in 80% less time than conventional parking, as there is no manoeuvring or looking for parking spaces required. Cars and their contents are protected from damage, theft and vandalism as no one drives or has access to them once they enter the car parking. Clients keep their keys and the car is locked at all times.

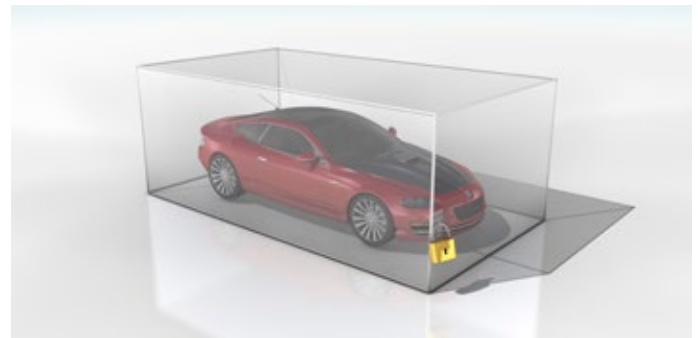

### 5. Efficiency and Economy

In many locations, Skyline APS can be the most economical or only possible construction choice as well as the most profitable choice from the owner perspective. Reduced development costs, increased parking density, lower energy costs and utilization of lower valued land or building underground are just a few of the ways that APS can help you achieve ROIs up to 12%.

## Skyline Features

<b>Fast Parking &amp; Retrieval Time</b>	<ul style="list-style-type: none"> <li>&lt; 60 sec = <b>fastest APS technology</b> on the market due to conveyor belts</li> </ul>
<b>Reliability &amp; Maintenance</b>	<ul style="list-style-type: none"> <li>Primarily COTS (commercial off-the-shelf) components</li> <li>High mechanical, heat &amp; humidity tolerances</li> <li>Field-proven over +20 years</li> </ul>
<b>Space Efficiency</b>	<ul style="list-style-type: none"> <li>Multi-sized (length, width &amp; height) parking spaces to maximize space efficiency</li> <li>Reduced building height due to lower ceiling heights in the parking area (no human access required)</li> </ul>
<b>Ease of Use</b>	<ul style="list-style-type: none"> <li>Large, bright and secure car entry/exit lobbies</li> <li>Easy to use driver interface</li> </ul>

## Product Range

We utilize *two very flexible designs*:

the **Skyline T** (“Tower”)-Park for freestanding applications and the **Skyline L-** (“Lateral”) for applications requiring customized or irregular facility shapes.



[▶ Animation „Scope of Products“](#)

### Skyline T-Park

The Skyline T-Park provides parking for up to 200 cars in a footprint of just 22m x 22m. With 16 parking spaces per level, and 5 to 13 levels, the Skyline T-Park is an extremely space-efficient and adaptable parking solution. Up to eight entry and exit lobbies on different sides and different levels allow for superior ease of use for customers and optimum traffic patterns. Whether configured as a single tower or multiple towers clustered together, the Skyline T-Park is ideal for providing the most parking spaces in a very small area and volume.

- Freestanding tower for above or below ground
- Car retrieval times of under 60 seconds
- Double the density of conventional parking
- Up to 200 parking spaces capacity in a 22m x 22m footprint
- Secure & spacious vehicle lobbies
- Between 5 and 13 parking levels
- Up to eight entry/exit lobbies



[▶ Animation „T-Park“](#)

### Skyline L-Park

The Skyline L-Park allows you to put parking in otherwise impractical places as inside or under existing buildings or in narrow or irregularly-shaped spaces. Offering the most versatile and flexible design, the L-Park is scalable in three dimensions with parking spaces arranged either side-by-side or head-to-tail (laterally) to meet varying space requirements. The Skyline L-Park is the parking solution that fits where others can't.

- Highly flexible configuration
- For use above, under or inside new or existing structures
- Car retrieval times of under 60 seconds
- For 60 to several thousand cars per installation
- Adapt the parking layout to suit your building
- Secure & spacious parking lobbies
- Double the density of conventional parking



[▶ Animation „L-Park“](#)

## Applications

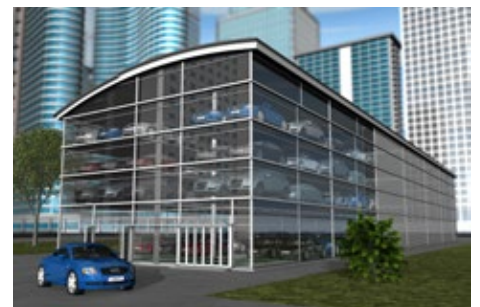
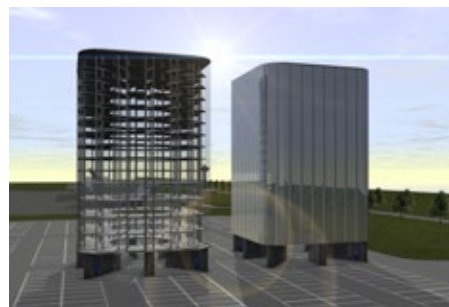
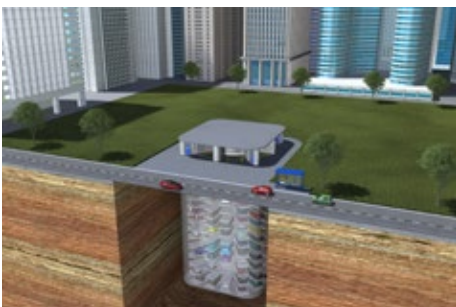
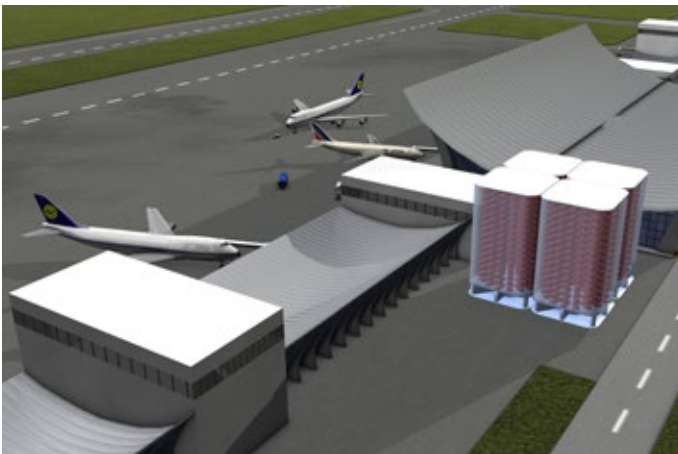

Find more information about possible applications in our specific fact sheets - contact us: [info@skyline-parking.com](mailto:info@skyline-parking.com).

## References



*AZW Zürich, Switzerland  
Parking & Storage Space for a Car  
Dealership*

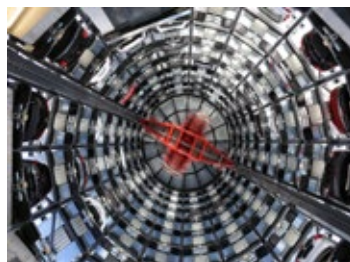
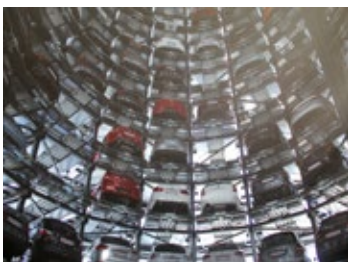

*City Parking Schaffhausen,  
Switzerland  
The only public Automated Parking  
System in Switzerland*

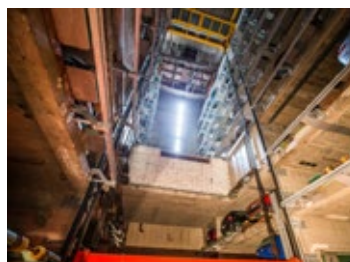

## Skyline Parking Core Values

Headquartered in Winterthur Switzerland, Skyline Parking AG designs and delivers state-of-the-art Automated Parking Systems for 60 to several thousand cars. Providing automated parking solutions is our focus and our only business.

Our goal is to deliver the best possible parking solutions in terms of **reliability, performance and user satisfaction**.

Skyline employees orient themselves on the three corporate values of **innovation, value creation and sustainability**.

### Innovation

We endeavor to deliver the most efficient, reliable and user friendly automated parking systems in the industry through innovative product and service solutions. Our unique design features and continued investment in product design demonstrates our passion and devotion for engineering excellence in automated parking solutions.



### Value Creation

We aim to exceed the expectations of our clients in everything we do - from the first sales contact to the customer handover of an APS project and ongoing maintenance and customer support.



### Sustainability

We are committed to providing best in industry sustainable APS solutions. We are constantly improving and developing sustainable automated car parking solutions. Our vision is to be good corporate citizens and environmentally responsible individuals in everything we do.



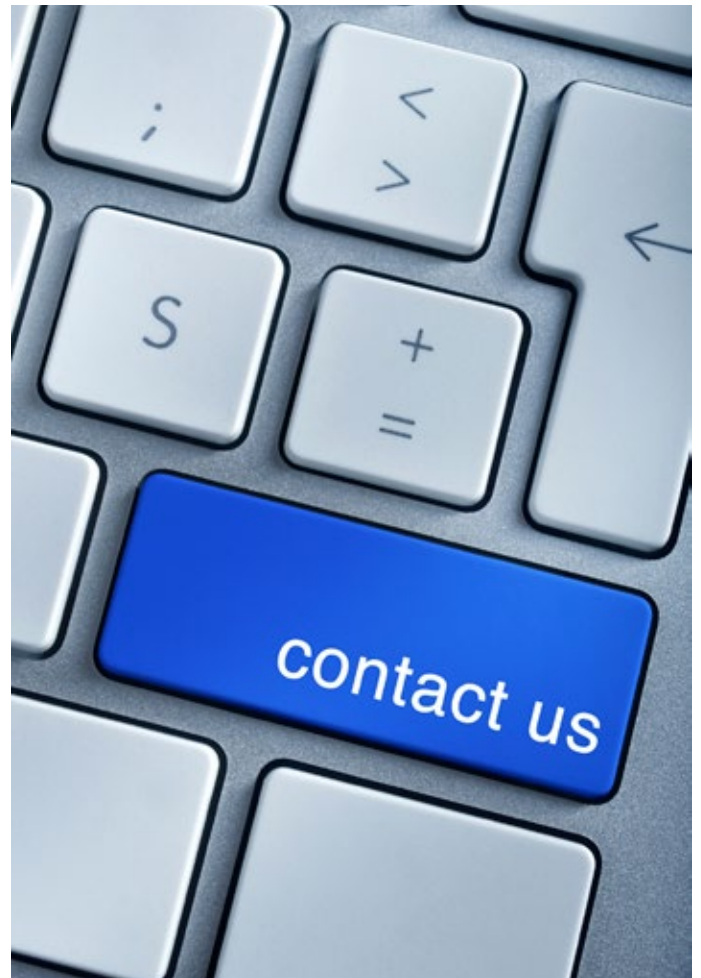

### Contact details

**Skyline Parking HQ**  
Lagerhausstrasse 3  
8400 Winterthur  
Switzerland

Tel +41 52 203 00 03  
[www.skyline-parking.com](http://www.skyline-parking.com)  
[info@skyline-parking.com](mailto:info@skyline-parking.com)

*Find our Sales offices on [www.skyline-parking.com](http://www.skyline-parking.com).*